

# Stonehollow 1

11525-1 Stonehollow Drive - Austin, TX 78758

**42,374 SF**  
**Office/Warehouse**

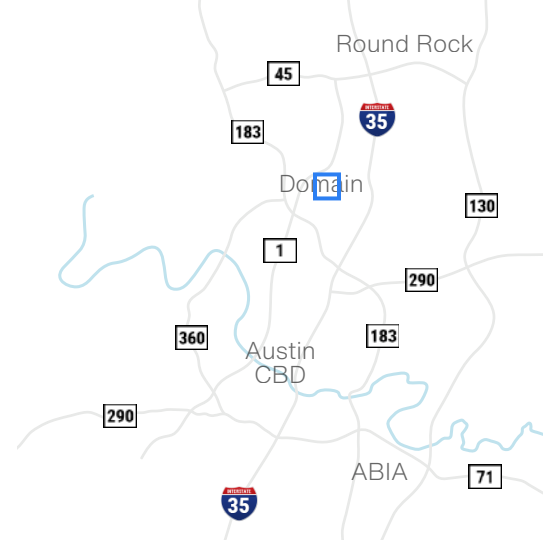

Available Suites

**Suite 100 - 42,374 SF**

## Building Features



**100% Creative Office,  
Mix of Open and  
Private Offices**



**11 Dock High Door**



**Large Break Room &  
Two Restroom Cores**



**Sits in North Austin  
- Home to many B2B  
Companies, Breweries,  
and Crossfit/Fitness  
Gyms**



**5 Mins. from Austin's  
Domain District  
-50+ Restaurants  
-775+ Hotel Rooms  
-2,700+ Apt. Units**



**Davis Bass**  
bass@hpitx.com  
(512) 203-5130

**Brooks Benkendorfer**  
brooksbenkendorfer@hpitx.com  
(512) 848-2582

No warranty or representation, expressed or implied, is made as to the accuracy of the information contained herein, and same is submitted subject to errors, omissions, change of price, rental or other conditions, withdrawal without notice, and to any special listing conditions imposed by the principals.

# Stonehollow 1

11525-1 Stonehollow Drive - Austin, TX 78758

**Suite 100**  
**42,374 SF**

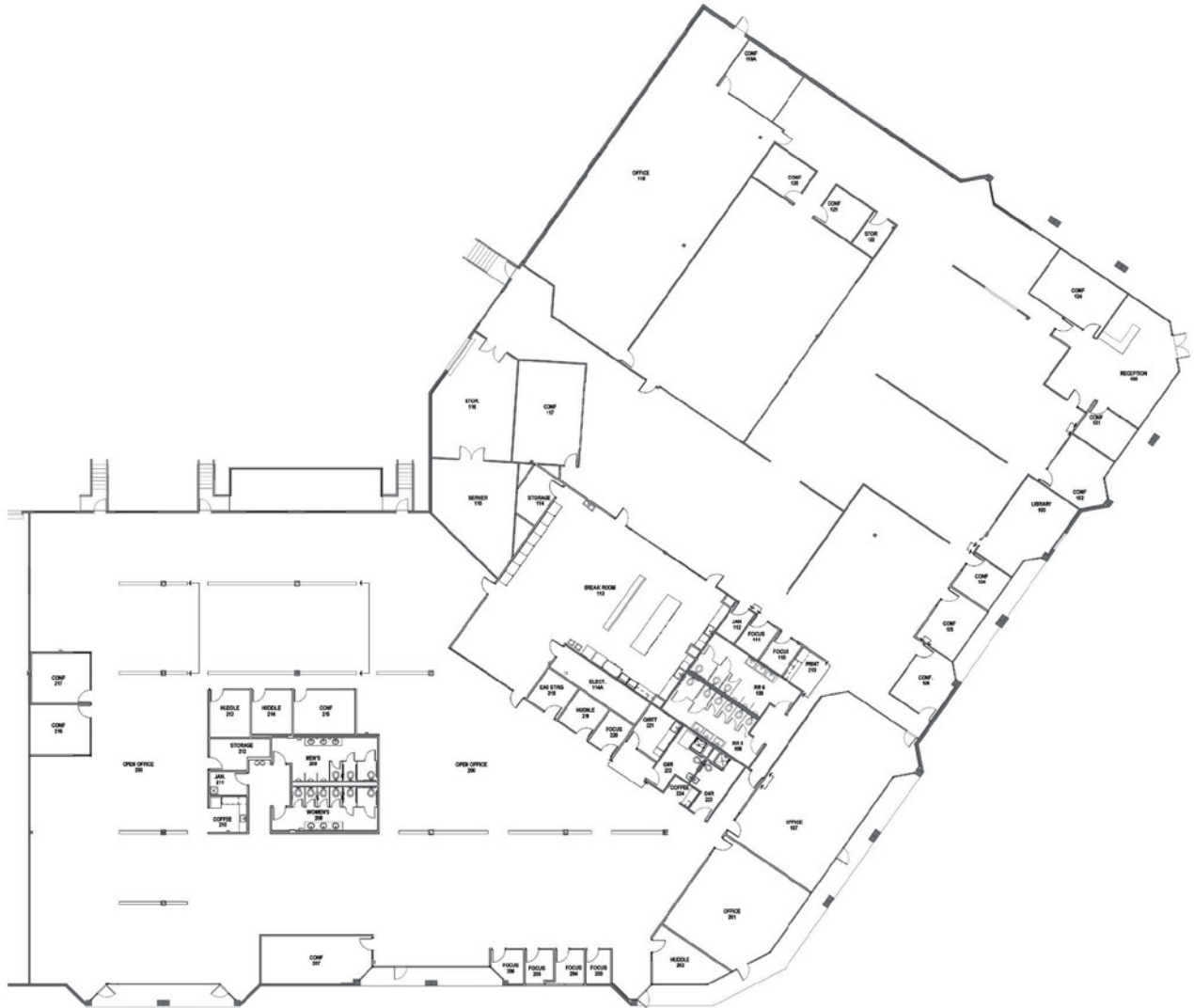

**Davis Bass**  
bass@hpitx.com  
(512) 203-5130

**Brooks Benkendorfer**  
brooksbenkendorfer@hpitx.com  
(512) 848-2582

No warranty or representation, expressed or implied, is made as to the accuracy of the information contained herein, and same is submitted subject to errors, omissions, change of price, rental or other conditions, withdrawal without notice, and to any special listing conditions imposed by the principals.